

FM001-L2

MR4

Instructions

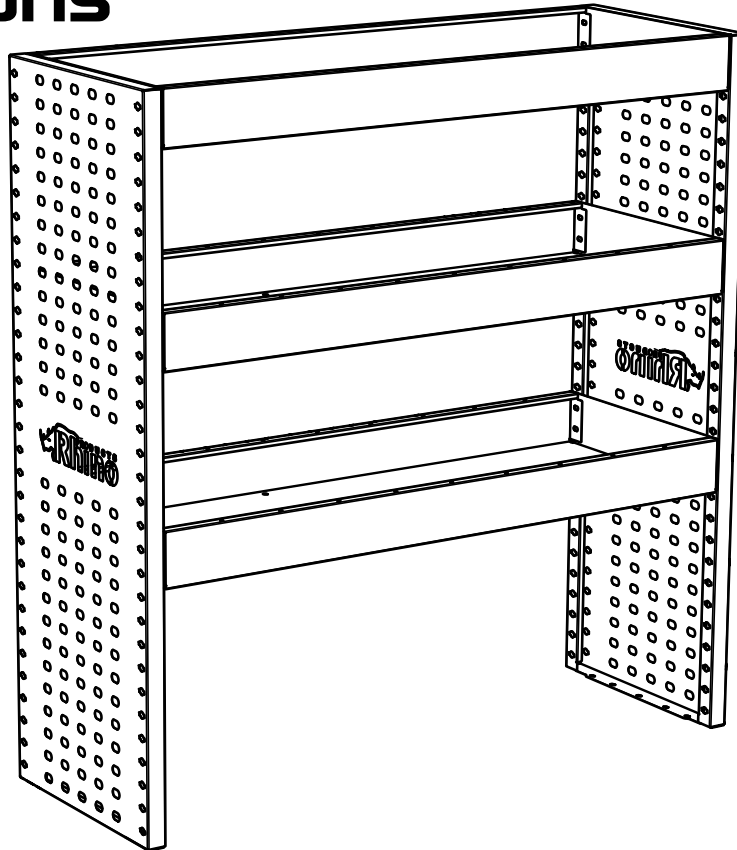

CITY CRASH (✓)

According to ISO/ PAS 11154:2006

MR4
Weight
 18.6kg
 /41.0lbs
 (Bay 1)

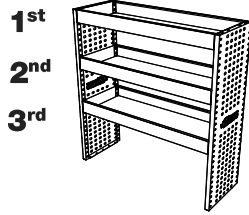

Shelf Max Load
1st 10.0kg/22.0lbs
2nd 35.0kg/77.2lbs
3rd 35.0kg/77.2lbs

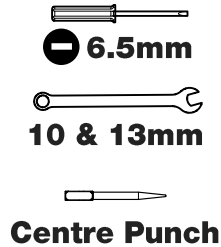
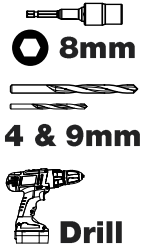
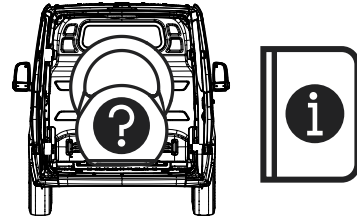

Assembly
 ≈25min
Fitment
 ≈25min

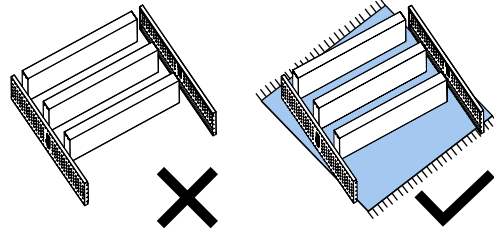

MR4

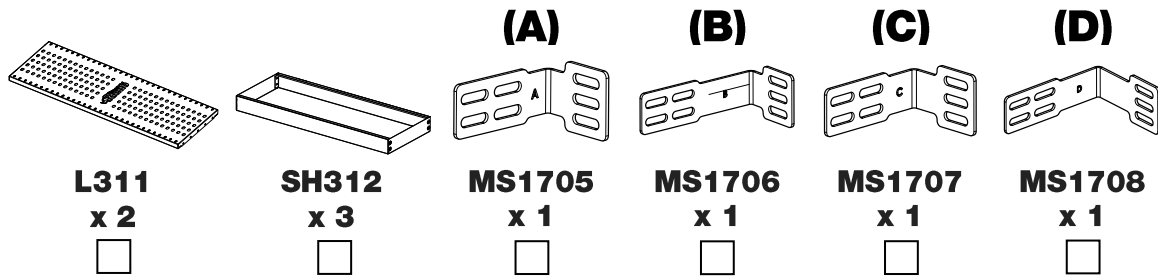

Fitting Kit

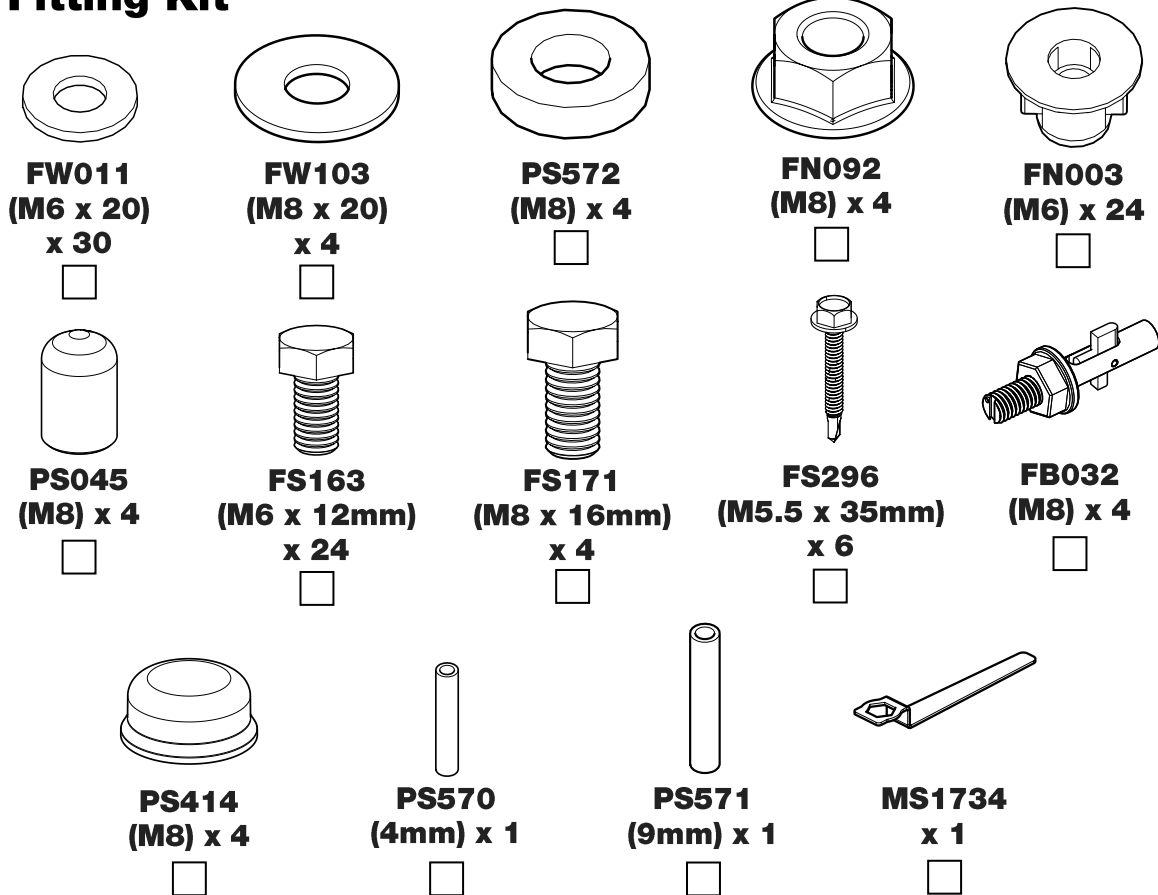

FORD TRANSIT CUSTOM (2013-) L2-H1

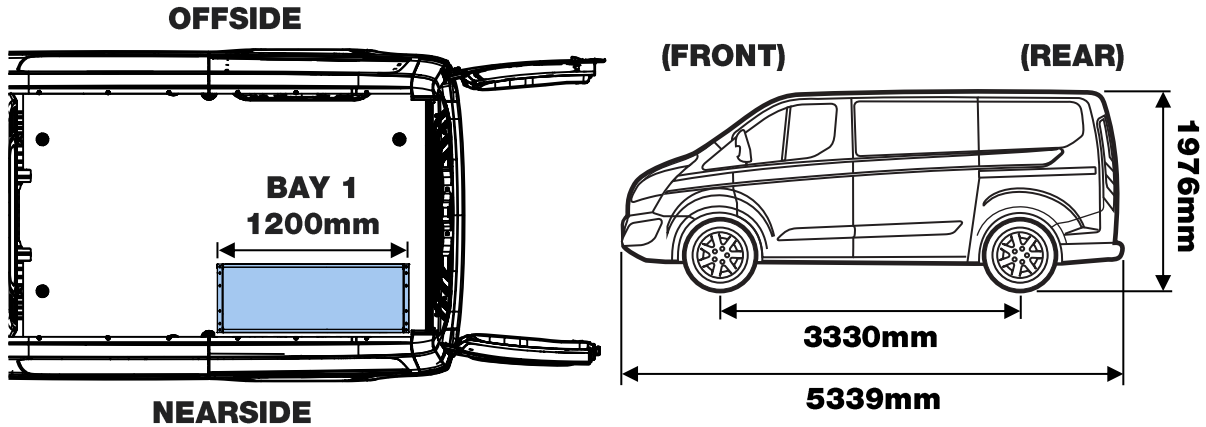

1.

SH312 (BAY 1)

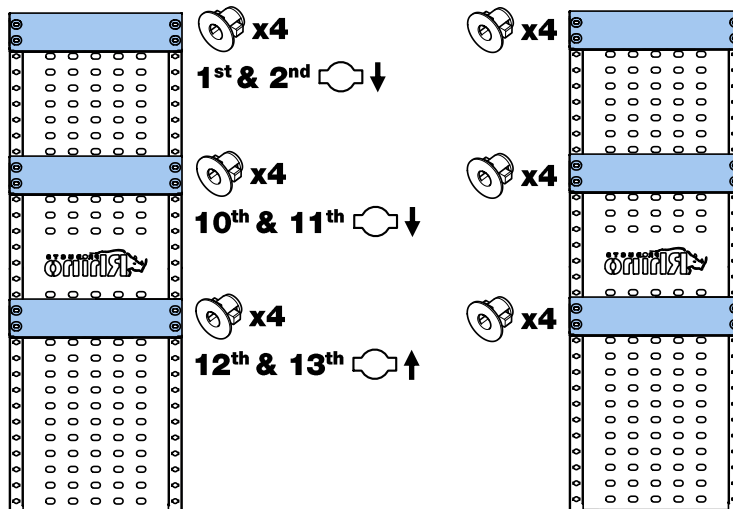
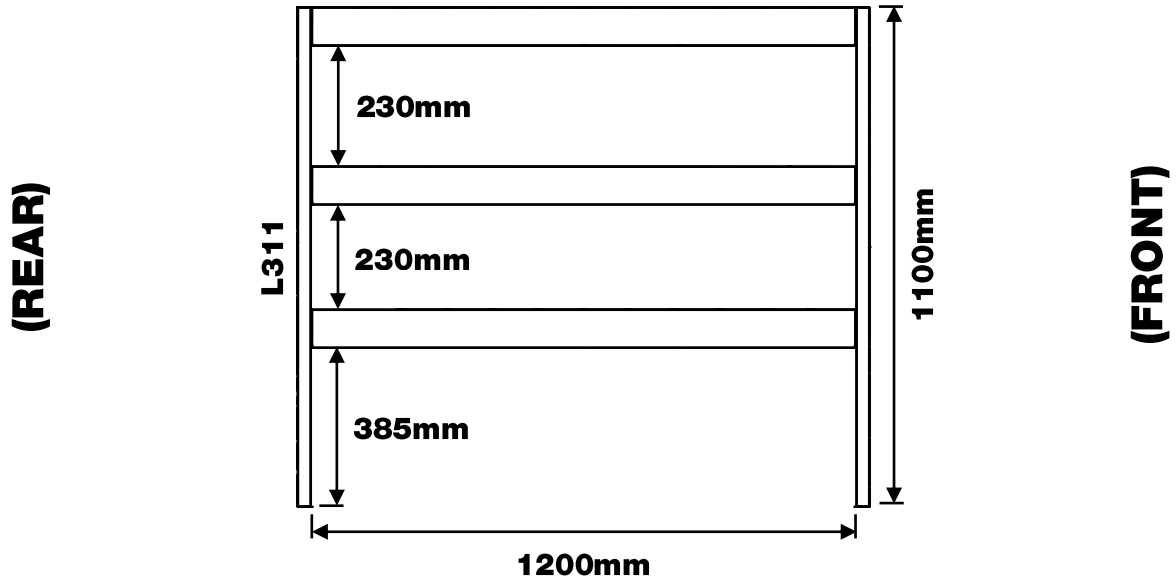

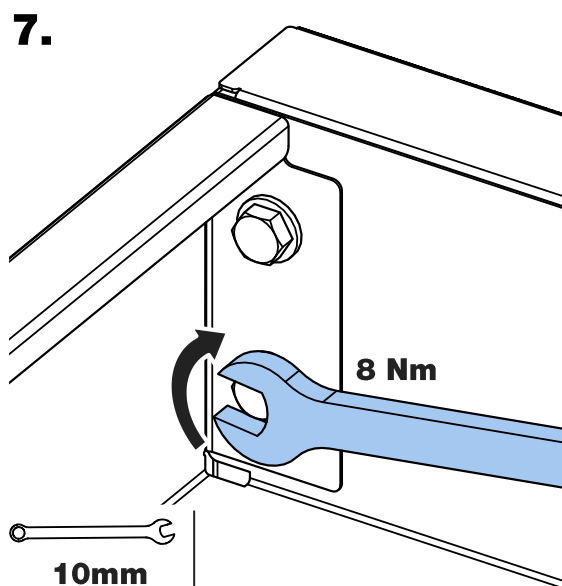
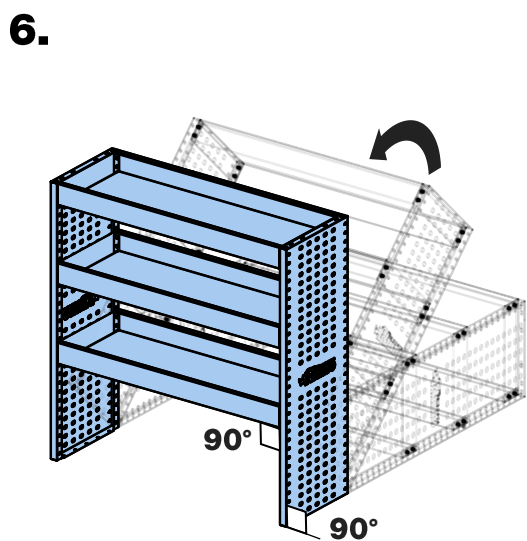
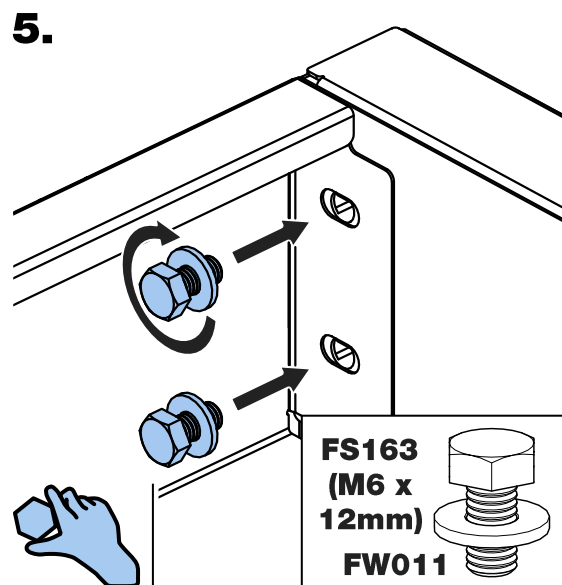
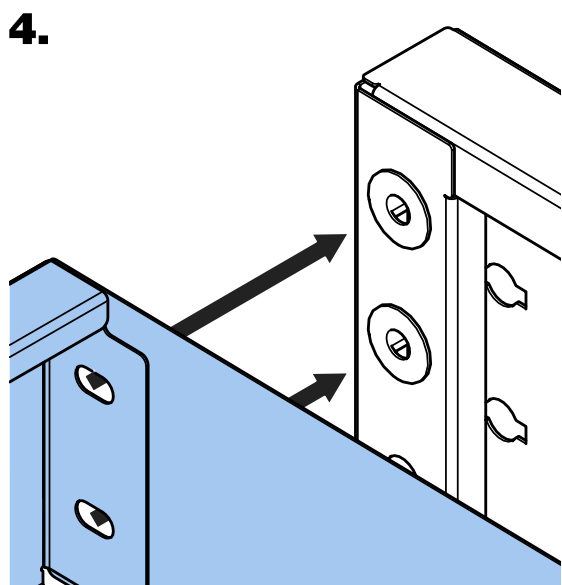
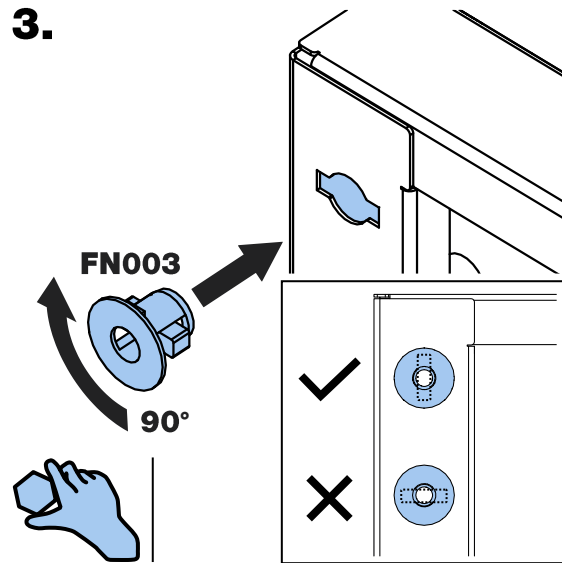
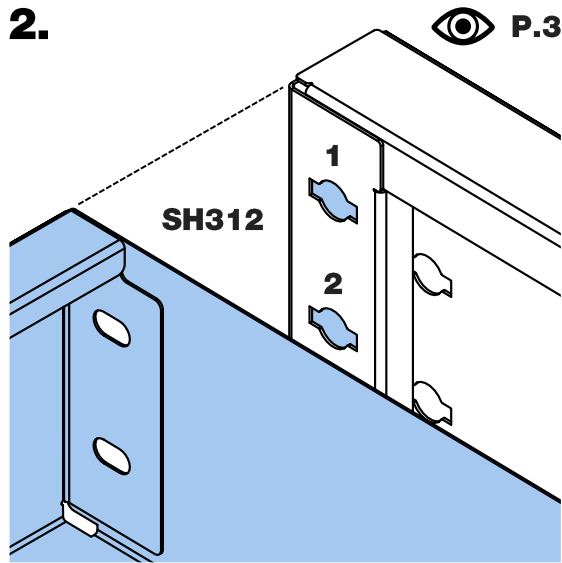

∞.

(REAR)

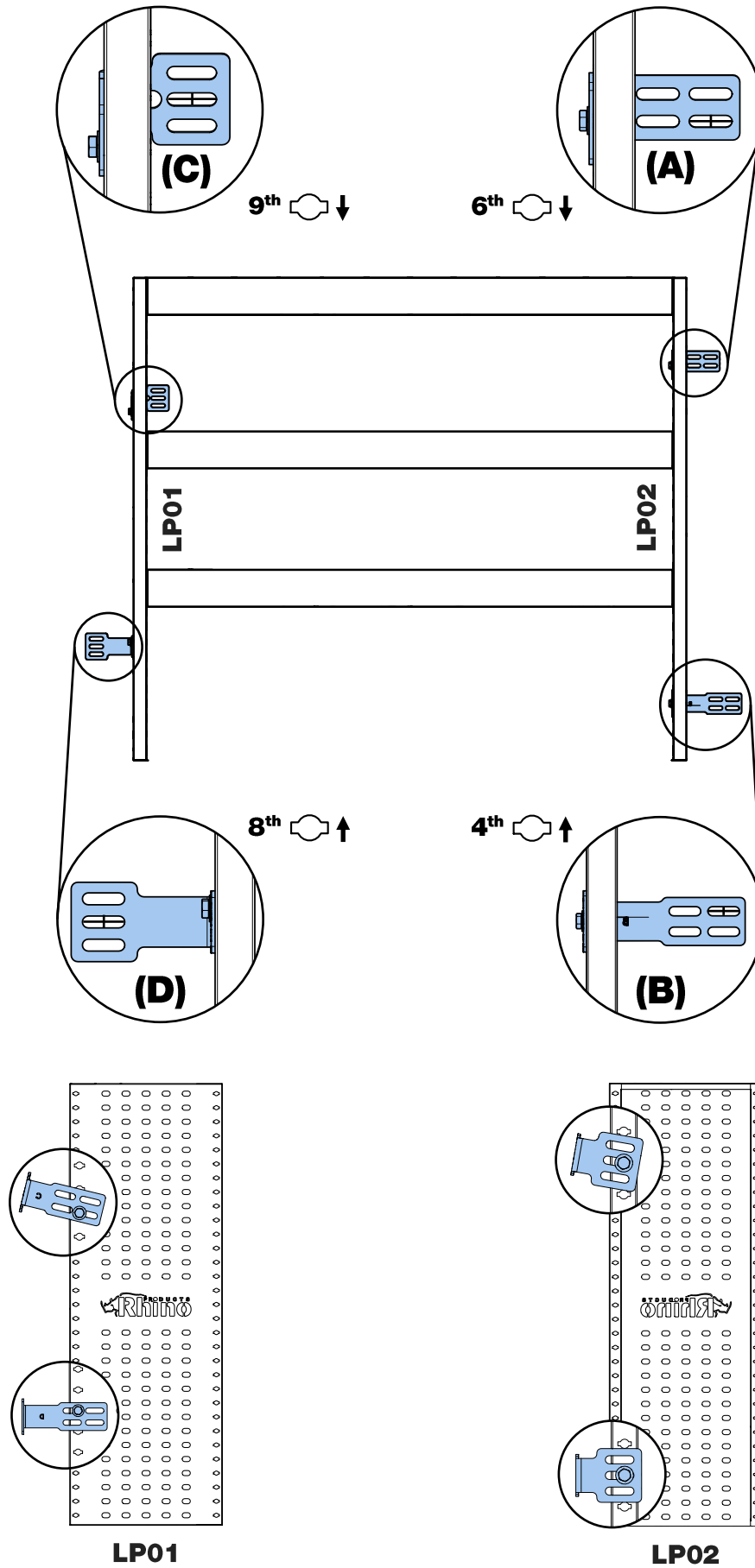

(FRONT)

9.

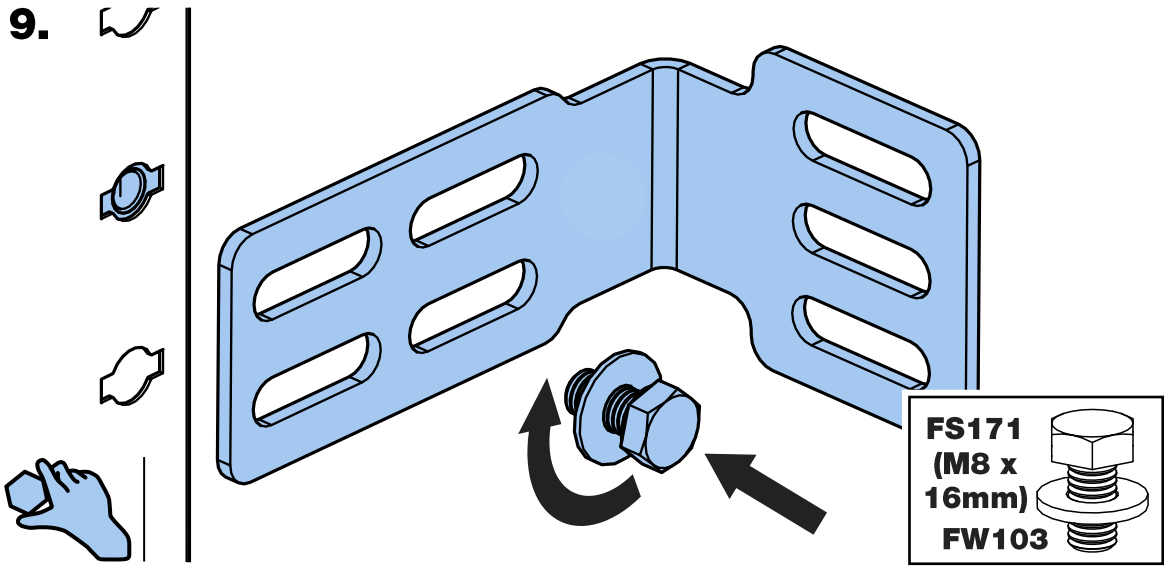

10.

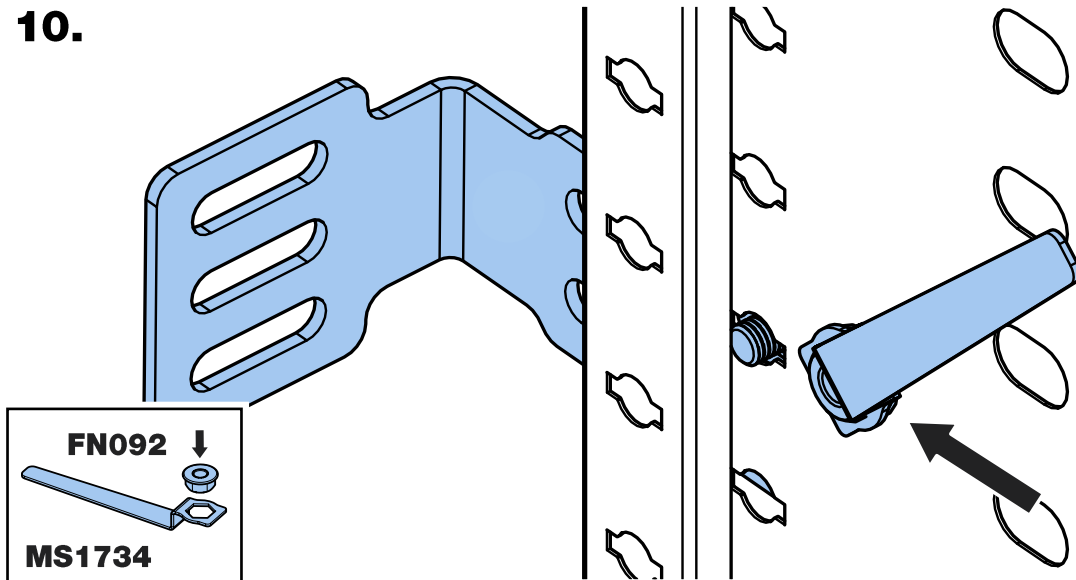

11.

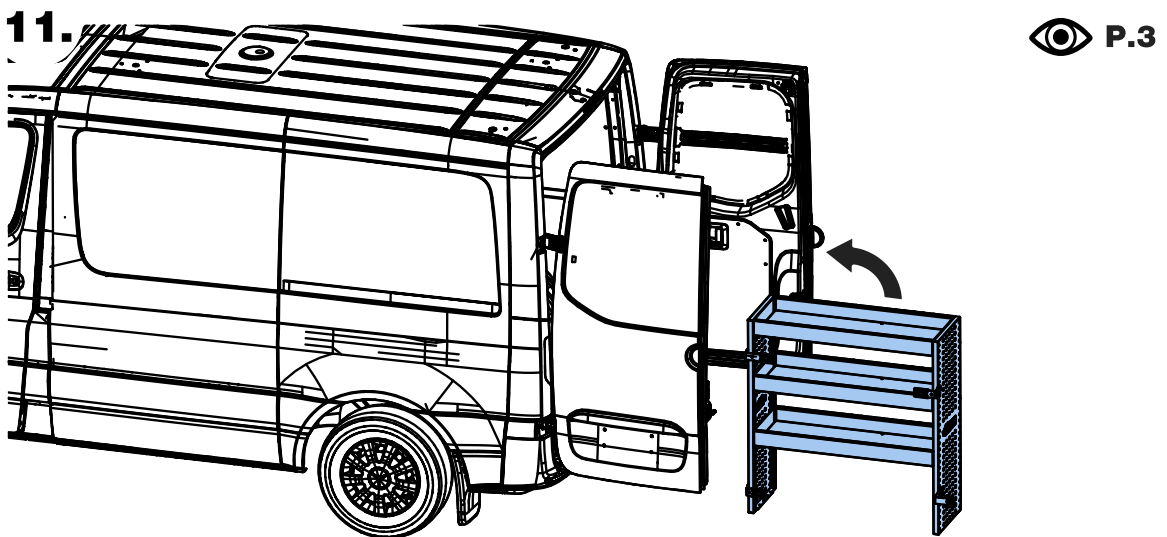

12.

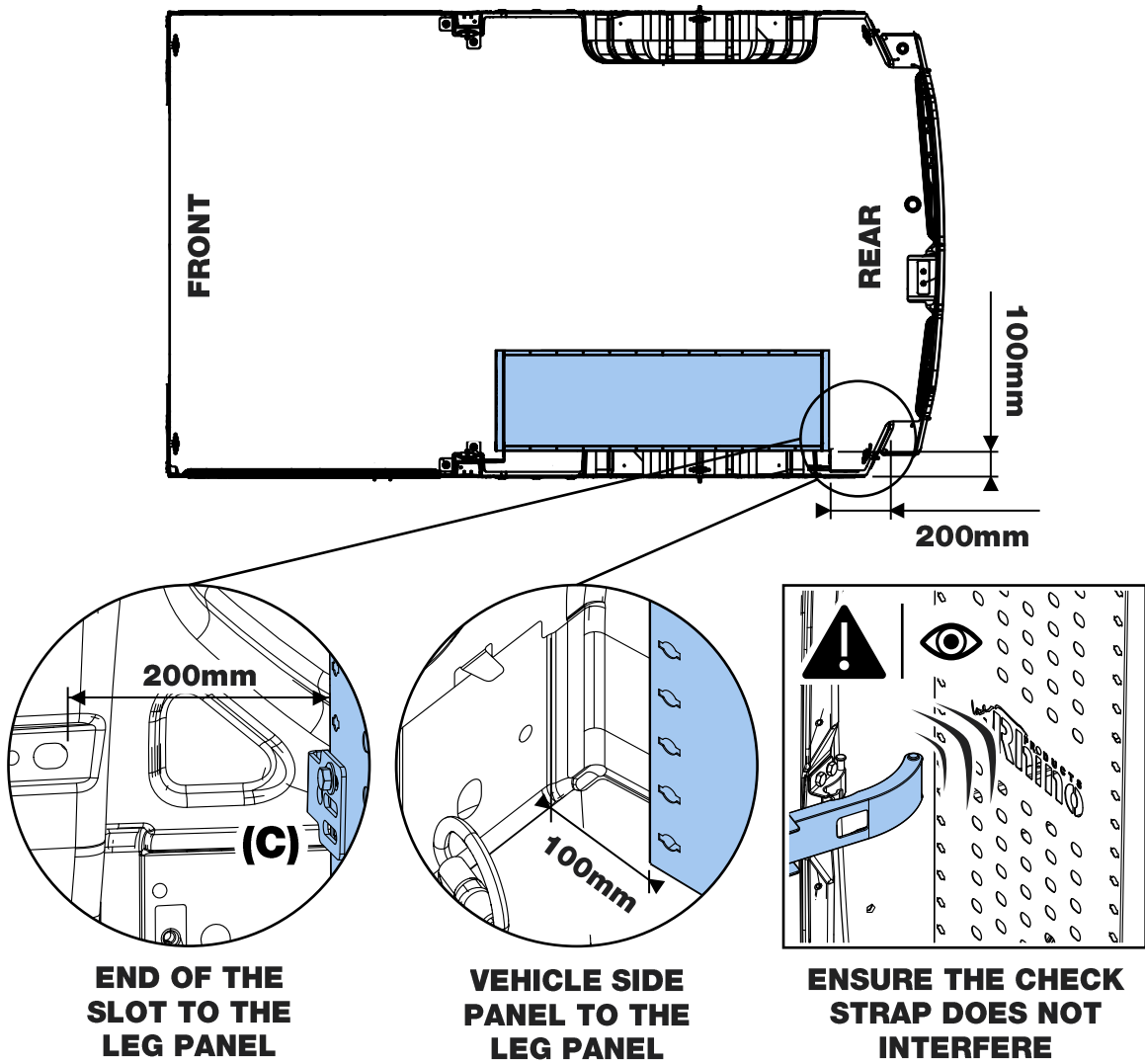

13.

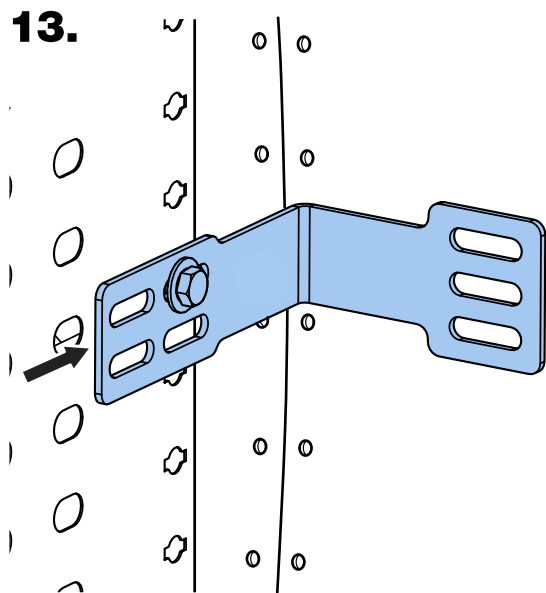

14.

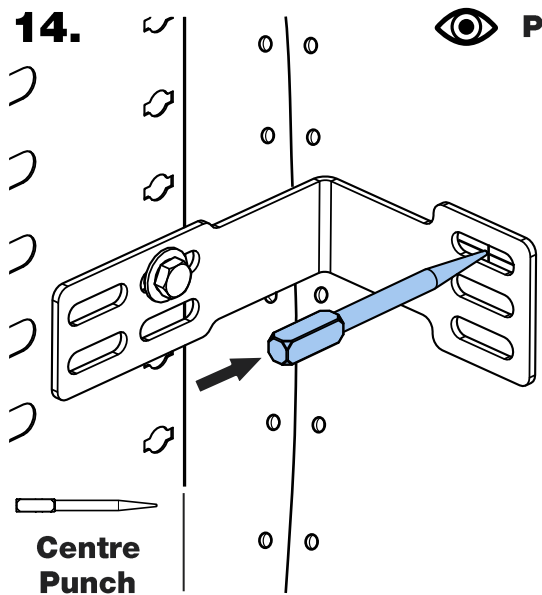

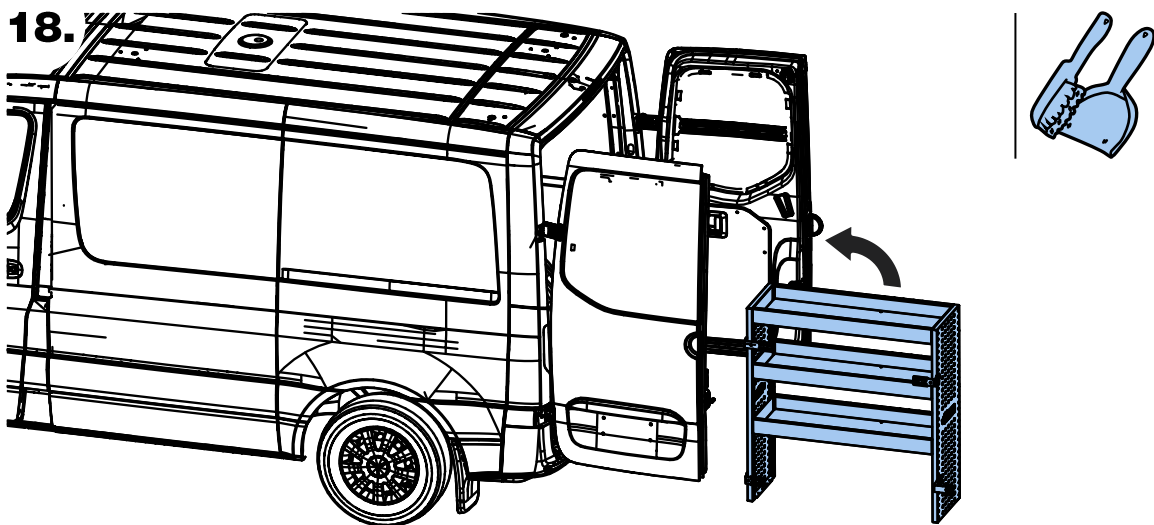
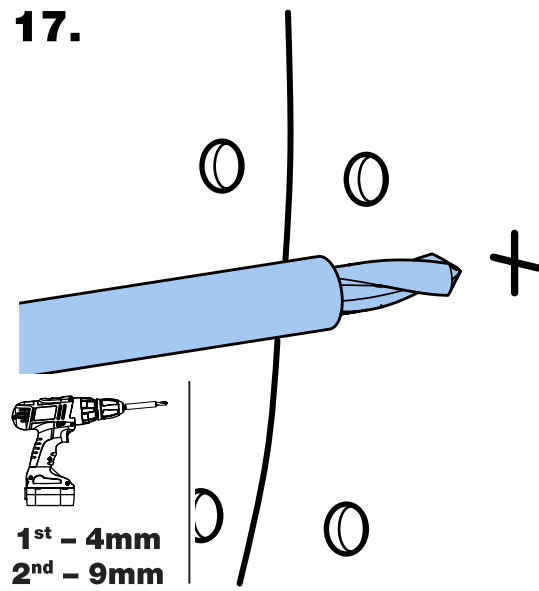
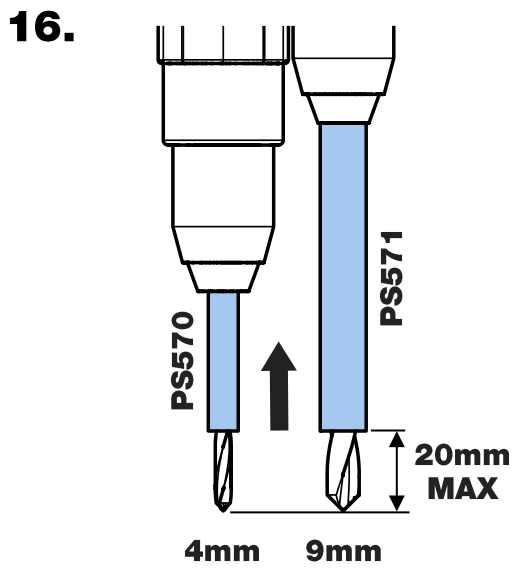
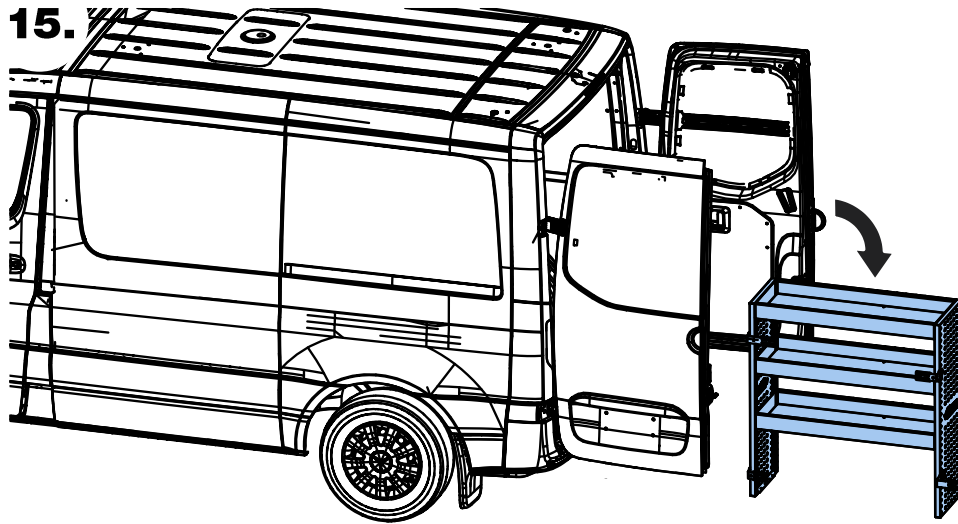

19.

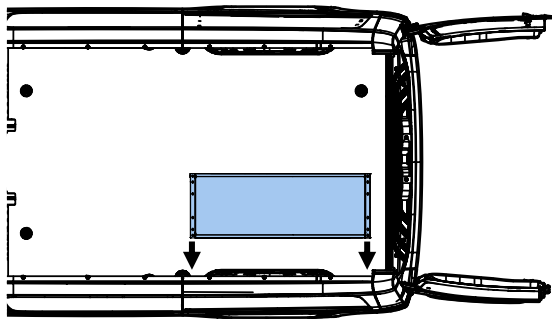

20.

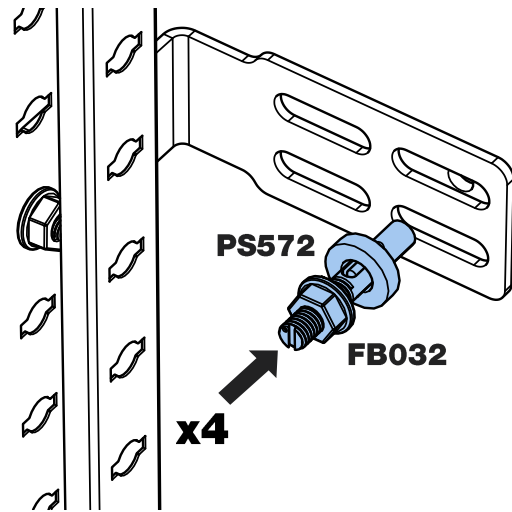

21.

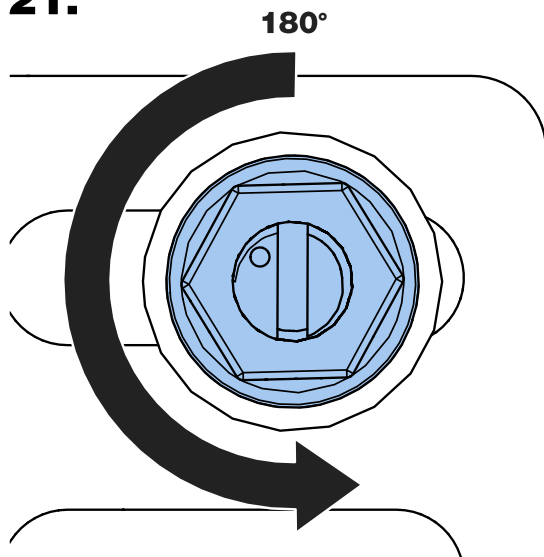

22.

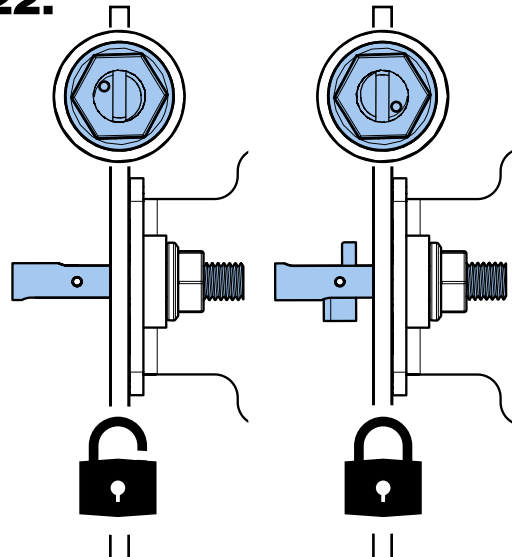

23.

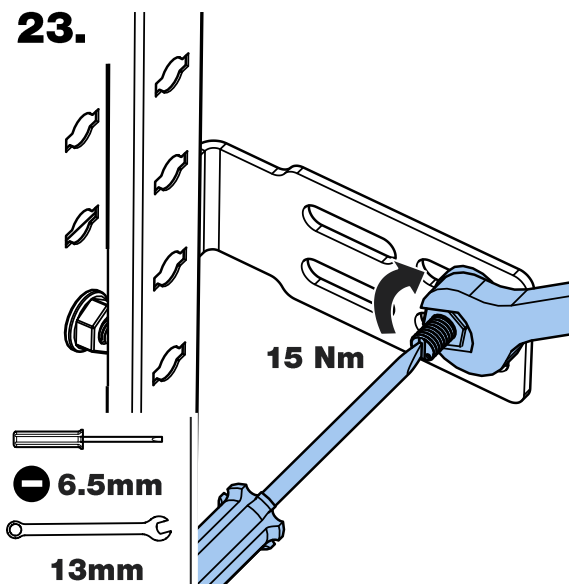

24.

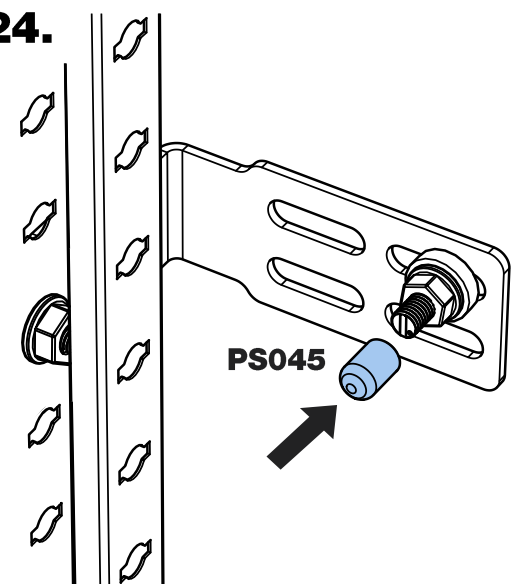

25.

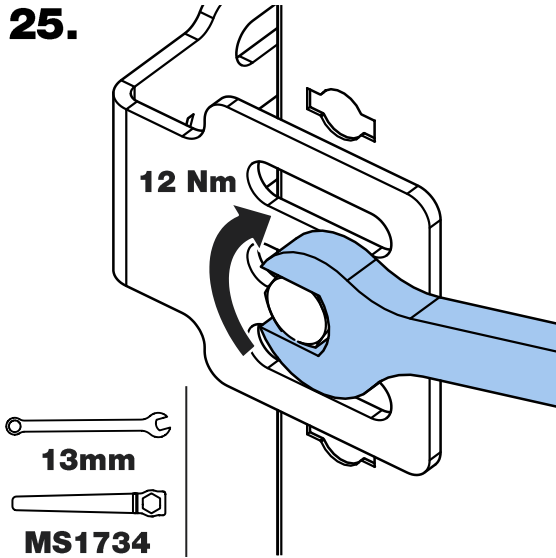

26.

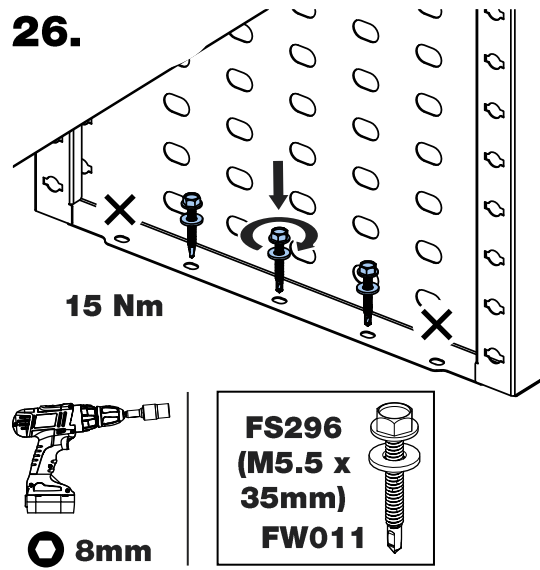

27.

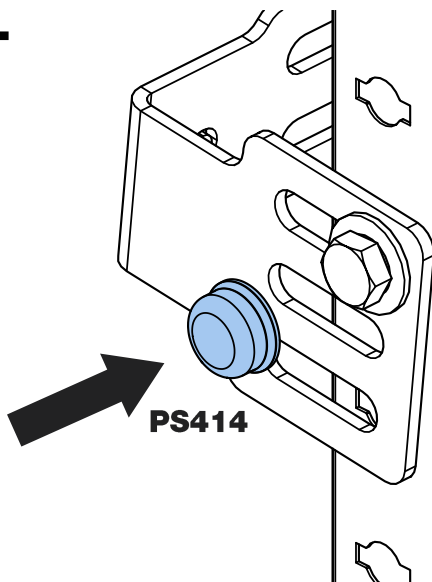

28.

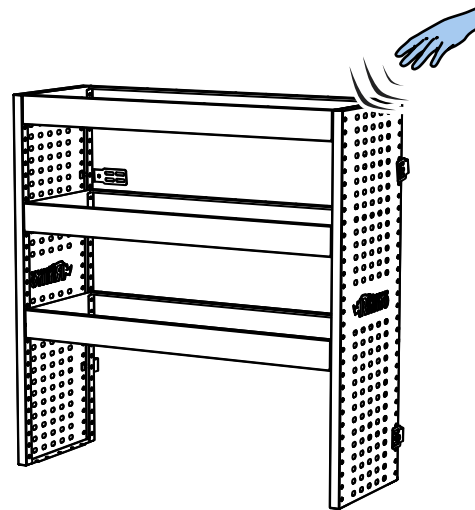

Check every 3 months to ensure the fixings are secure.